

LIQUID COOLING

Series KW

dau

A Miba Group Company

APPLICATION

DAU has developed Series-KW a liquid cold plate for high power IGBT and resistor applications. DAU offers high performance customized solutions for all IGBT and resistor types available on the market.

GENERAL CHARACTERISTICS

The desired length and number of mounted IGBT and resistor units is customer specific. To further increase thermal cooling performance of the DAU KW Series, DAU has developed a special flow accelerator called turbulator which increase the coolant velocity in the channels with only minimal increase in system back pressure. DAU recommend the use of turbulators generally and especially with glycol mixtures. The position of the water channels are designed to mount nearly all available semiconductors on the market.

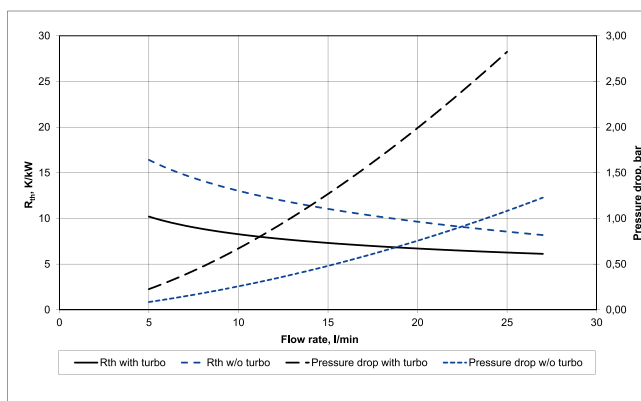

DESCRIPTION

No. of modules: 1
Module size: 130x140 [mm]
Power dissipation: 1000 [W/modul]
Thermocouple: Type K
Fluid type: H₂O
Fluid inlet temperature: 50 [°C]

Series KW 140

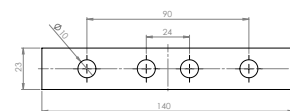

Series KW 188

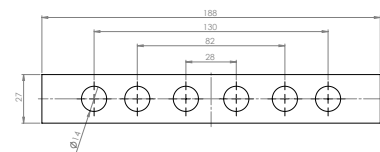

Series KW 200

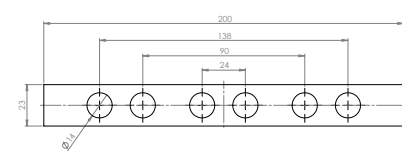

Series KW 215

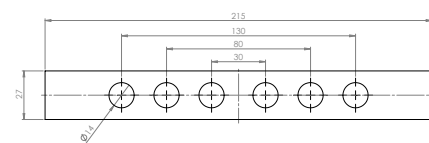

LIQUID COOLING

Series KW



A Miba Group Company

TYPE-OVERVIEW

